

1.6" square

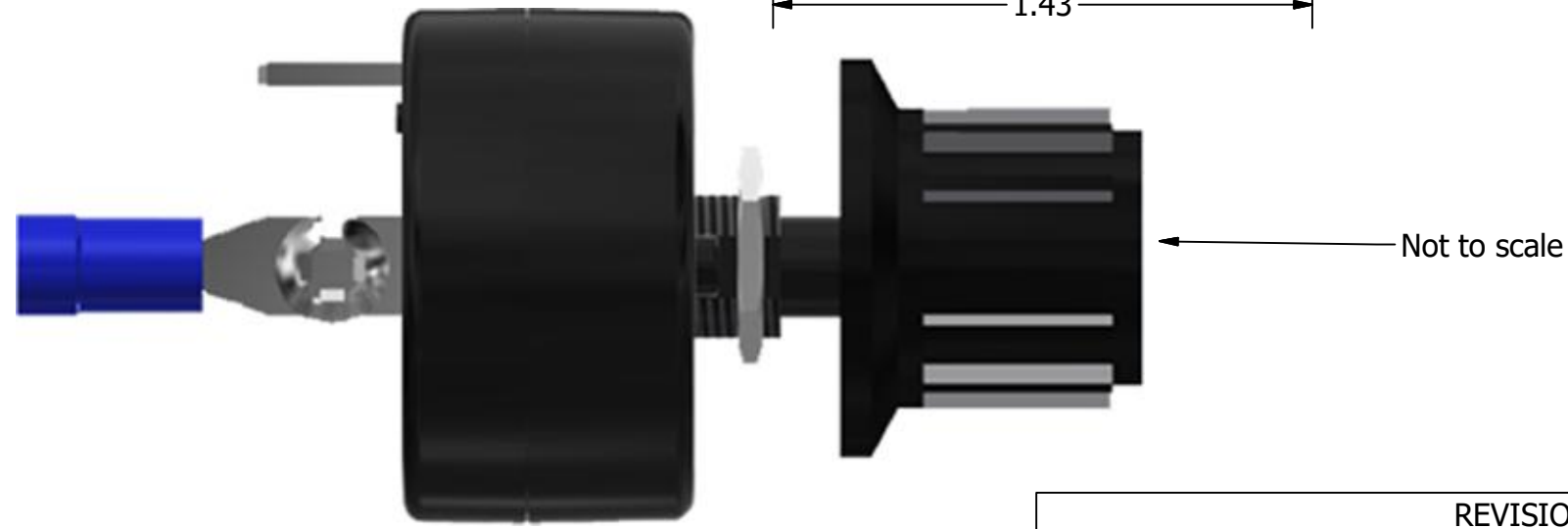
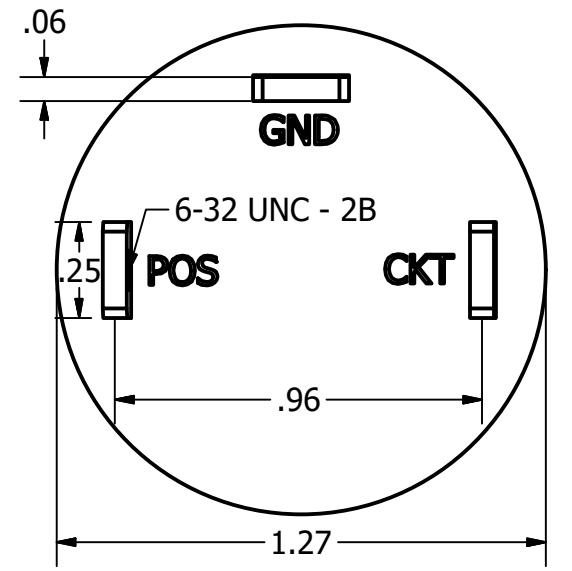
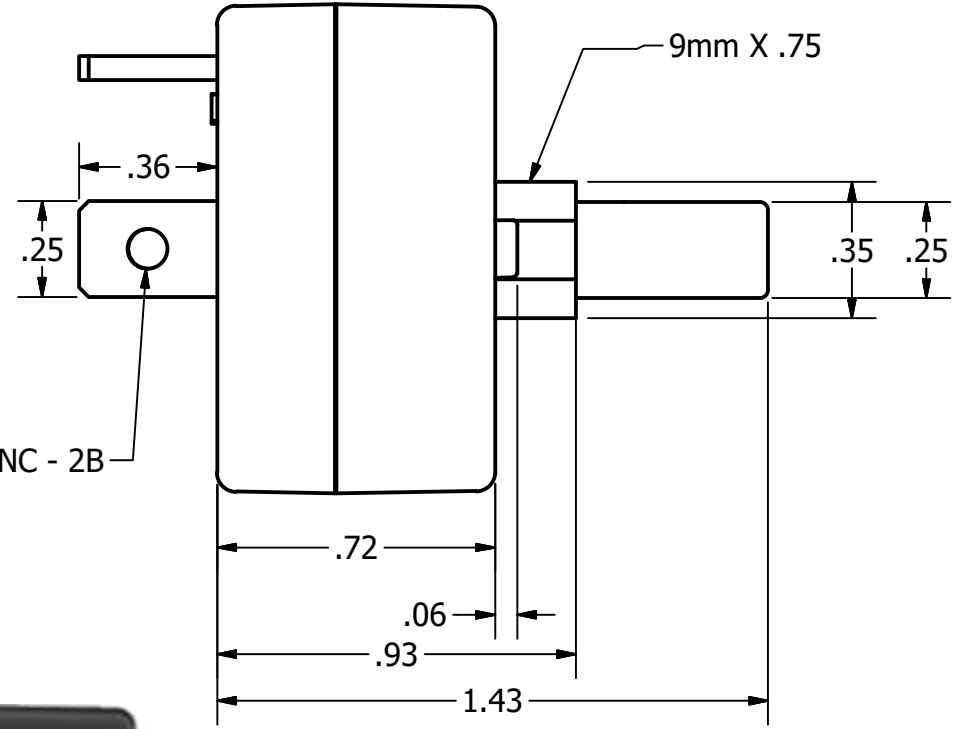
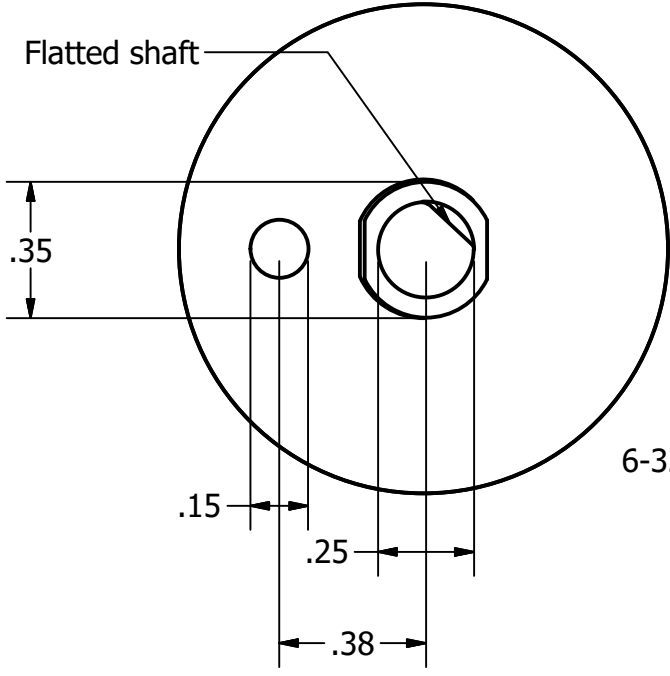

PARTS LIST	
1	MaxDim w/ring lugs
1	Optional Installation Instructions
3	Color Coded Spade terminals
1	Optional Reference panel label
1	Optional STC Printout for logs
1	Optional Installation Template, Placards
1	Knob
3	6-32 screws, lock washer for terminals
2	Allen Wrenches
1	M9 x .75 Bushing Nut

SPECIFICATIONS	
STC/PMA	SA01800SE/PQ2574NM
DO-160E Testing	SEC. 21: RFE (EMI)
Voltage Range	12 to 35 VDC
Maximum Current	12.5 A per Channel
Output Channels	1
Internal Temp Protected	+85 degrees C
Enclosure Material	Bayer FR110 Resin meets UL94
Weight	1 ounce (28g)
Warranty	One Year Limited
Storage Temperature	-40C to +100C
Operating Temperature	-30C to +85C
Internal Temp	+25 C at 10 A

DIMENSIONAL TOLERANCES		
Fractions	Decimals	Angles
+/- 1/32	.XX +/- .08	+/- 1 degree
	.XXX +/- .010	
	X +/- .1	

REVISION HISTORY				
ZONE	REV	DESCRIPTION	DATE	APPROVED
All	--	Initial	3/3/2013	JB

DRAWN JB	3/7/2013	 <b>Seaton Engineering</b>
CHECKED JC	8/6/2013	
QA		
MFG JB	3/8/2013	<b>9100-001-B MaxDim w/ring lug terminals</b>
APPROVED JB	3/8/2013	
SIZE <b>B</b>	DWG NO <b>9100-001-B</b>	REV --
SCALE 2 : 1	SHEET 1 OF 1	